

Lean Tubing and Components

Benefits:

- Economical Solutions for Lean Manufacturing
- Components Compatible with Industry 28mm Dia. Tubing
- Stock Lengths Available in 2M and 4M Bars
- Gravity Roller Tracks

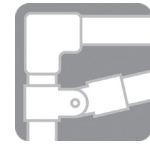



Lean Tubing

Benefits:

- 1mm Wall Tubing Available in White, Ivory, Red, Blue, & Black
- 0.8mm Wall Black ESD and Stainless Steel
- Stock Lengths Available in 2M and 4M Bars
- 4M Bars Sold in Packs of 10 Only
- Custom Colors are Also Available Upon Request
- Additional Wall Thickness Also Available Upon Request

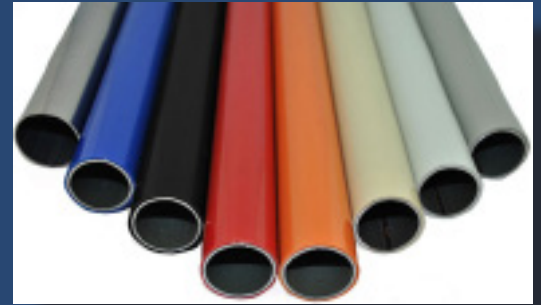

Description	Color:	2000mm Part No:	4000mm Part No:
White 1mm Wall Tube		H-2000-WHT	H-4000-WHT
Ivory 1mm Wall Tube		H-2000-IVO	H-4000-IVO
Blue 1mm Wall Tube		H-2000-BLU	H-4000-BLU
Black 1mm Wall Tube		H-2000-BLK	H-4000-BLK
Red 1mm Wall Tube		H-2000-RED	H-4000-RED
Stainless Steel 0.8mm Wall Tube		H-2000-SS	H-4000-SS



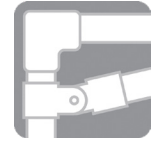

Metal Joint Seats

Benefits:

- Economical Solution for Lean Manufacturing
- Components Compatible with Industry 28mm Dia. Tubing
- Components Sold as Complete Assemblies
- Electrophoretic Coating/Chrome Plated



HJ-1



HJ-2



HJ-3



HJ-4



J-110



HJ-5



HJ-6



HJ-7



HJ-9



HJ-8



HJ-10



HJ-13



HJ-12

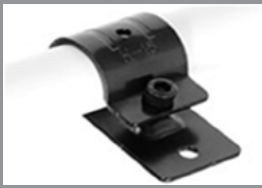

EL-401B



HJ-9



HJ-90



HJ-180

Floor to Frame



TX-0013



EF-1206S



J-105W

Roller Track Attachment



Description	Part No:
Flush Rigid Mounting Bracket	79-110-0
Recessed Rigid Mounting Bracket	79-120-0



Description	Part No:
Flush Inline Mounting Bracket 2 Prong	79-130-0
Flush Inline Mounting Bracket 1 Prong	79-140-0



Description	Part No:
Above Tube Mounting Bracket	79-150-0



Lean Rollers and Guides

Description	Part No:
Roller Track R28 - Grey - 2000mm Long	79-010-0
Roller Track R28 - Grey - 4500mm Long	79-020-0
Roller Track R28F - Grey - 2000mm Long	79-030-0
Roller Track R28F - Grey - 4500mm Long	79-040-0
32mm Lateral Guide Rail - Grey - 2000mm Long	79-210-0
32mm Lateral Guide Rail - Grey - 4500mm Long	79-220-0



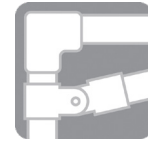

Tube Casters

Available in 50mm, 75mm, 100mm & 125mm Sizes



Description	Part No:
3" Swivel Caster with Brake, PU	31-STD3PU-1
4" Swivel Caster with Brake, PU	31-STD4PU-1
5" Swivel Caster with Brake, PU	31-STD5PU-1



Description	Part No:
3" Swivel Caster No Brake, PU	31-STD3PU-0
4" Swivel Caster No Brake, PU	31-STD4PU-1
5" Swivel Caster No Brake, PU	31-STD5PU-1



Description	Part No:
2" Swivel Caster with Brake, PU	31-STD2PU-1



Description	Part No:
2" Swivel Caster No Brake, PU	31-STD2PU-1

Tube Accessories

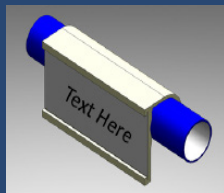

Description	Part No:
Plastic Label Clip	MS-02



Description	Part No:
Black Cap with M10 Thread	JL-49

MODULAR SOLUTIONS

Flotronics

AUTOMATION

Your Source for Lean Tubing & Components



**Modular Solutions
Flotronics Automation**

10435 Ortonville Rd
Clarkston, MI 48348
USA

P: (248) 625-8890

F: (248) 625-8818

sales@flotronicsautomation.com